

## Conector recto para prolongación aérea In-line receptacle

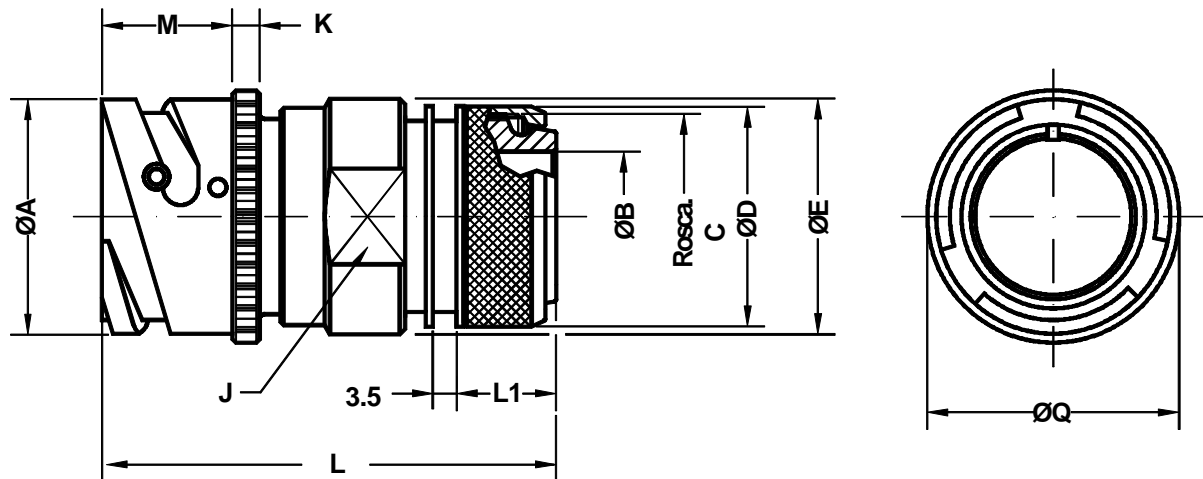

Ej. / Ex. : SCPB3101SP20-27P

Dimensiones de conector Shell size	Ø A 0 -0.1	Ø B m in.	Rosca C C thread	Ø D ±0.2	Ø E ±0.2	LL. J J key	K ±0.2	L Max.	L 1 Max.	M +0.2 0	Ø Q ±0.1
10 S L	18.2	8.5	M 16 x 1	18.5	22.0	20	2.8	52.0	13.5	14.3	21.8
14 S	24.5	12.0	M 20 x 1	22.3	25.0	23	3.3	52.0	13.5	14.5	28.8
16 S	27.2	14.5	M 23 x 1	25.3	28.0	26	3.3	54.0	14.6	14.5	30.5
16	27.2	14.5	M 23 x 1	25.3	28.0	26	3.3	63.0	14.6	19.1	30.5
18	30.7	17.5	M 26 x 1	28.0	30.0	28	4.0	64.5	14.6	19.1	33.8
20	34.0	19.5	M 30 x 1	32.3	34.5	32	4.0	64.5	14.6	19.1	36.9
22	37.3	22.0	M 32 x 1	34.3	38.0	36	4.0	64.5	14.6	19.6	39.5
24	40.9	25.0	M 36 x 1	38.3	41.0	39	4.0	66.0	14.6	20.6	43.9
28	46.7	29.0	M 39 x 1	41.2	48.0	46	4.0	66.0	14.6	20.7	48.4
32	53.4	34.0	M 45 x 1	48.3	54.0	52	4.0	67.5	14.6	22.3	56.0
36	59.6	38.5	M 52 x 1	55.0	61.0	58	4.0	68.0	15.5	22.3	62.4
40	65.5	48.0	M 59 x 1	62.0	68.0	65	4.0	68.0	15.5	22.3	68.6

Conector recto para prolongación aérea.  
Incluye zócalo estanco (grommet) y adaptador  
inspeccionable para terminación de pantalla y  
bota termorretráctil.

In-line receptacle.  
Includes wire sealing grommet and backshell  
with rotating clamp nut. Shielded cable is  
terminated with a "braid trap" nut and heat  
shrink tubing (optional).